

2-9-00	KDL	Separated from C337015B.	
2-14-00	KDL	Added Information.	

6 solder terminals for rotation sensor.

	If Encoder	If Resolver
X	White	Orange
Y	Black	Grey
Z	Red	Yellow
d	Orange	Blue
b	Yellow	Red
c	Violet	Black
	+5 to +20VDC	Oscillator High
	Ground	Oscillator Low
	Output A	Cosine High
	Output B	Cosine Low
	Output A ⊕ B	Sine High
		Sine Low

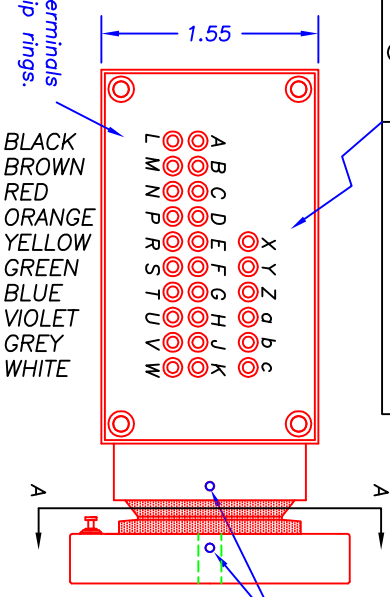
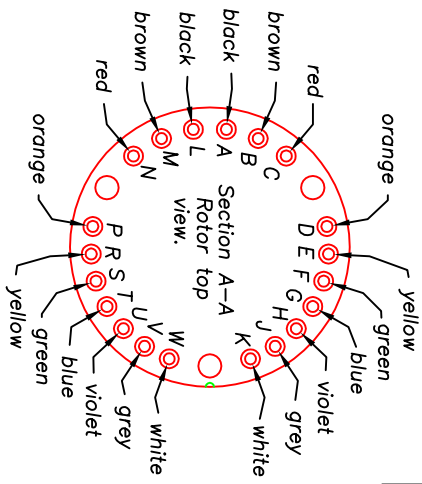

Note: If this unit will be used in wet weather, it should be ordered with rotary seals (W) and these 2 joints and all terminals need a sealant. Dow Corning 3145 RTV silicone rubber is recommended.

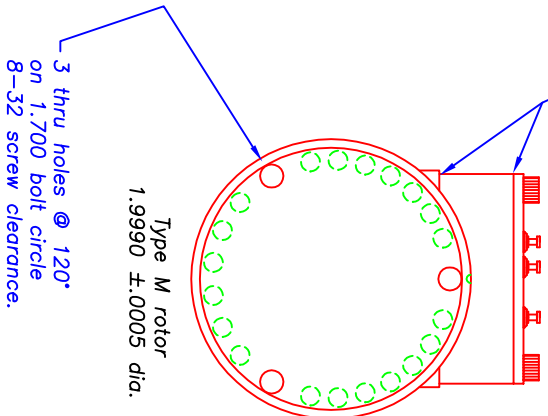
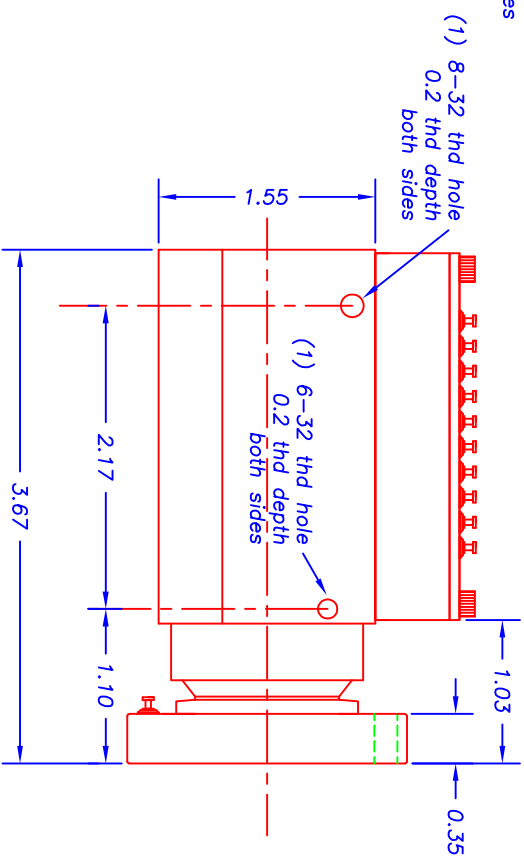
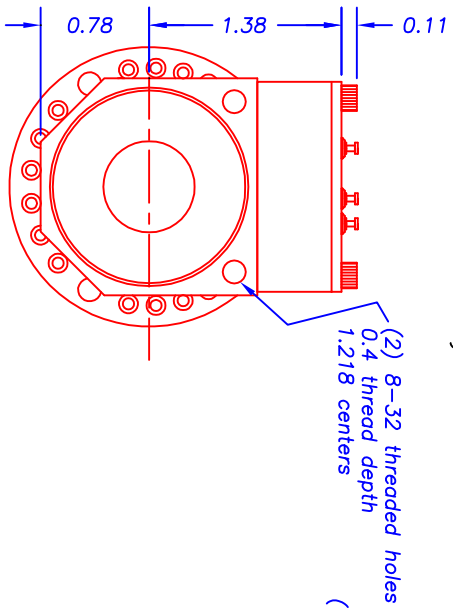

The encoders will operate from +5 to +20 Vdc. Current draw is 50 to 90 mA. Temperature range is -40C to +100C.

The resolvers require a 10 KHz, 16 V peak to peak sine wave oscillator. The Michigan Scientific model RESSC-2-12V resolver electronics includes this oscillator. Temperature range of resolver units is -40C to +120C (-40F to +250F).

SR/ERT series

Model SR20M/E----- Weight 13 ounces.

Model SR20M/R360 Weight 14 ounces.

20 SLIP RINGS & AN OPTICAL ENCODER (E-----) OR RESOLVER (R360) IN A NOT VERY WEATHERPROOF HOUSING.

08500 ANGE ROAD
CHARLEVOIX, MI 49720
PHONE: (231)547-5511 FAX: (231)547-7070

TOLERANCES		DESIGNED		DATE:		SCALE:	
.xxxx ±.0005	BY: KDL	7-8-98		1:1			
.xxx ±.005	DRAWN BY:			TITLE:			
.xx ±.01	KDL			OUTLINE DRAWING			
ANGLES ±----	CHECKED			SHT OF SHTS:		SIZE	
SURFACE FINISH	BY:			BH			
-----RMS							
DRAWING NO.:	MATERIAL:						
C337048B	20 RINGS & ENCODER OR RESOLVER.						